

“Ion Mincu” University of Architecture and Urbanism
 Faculty of Architecture
 Study Program: ARCHITECTURE
 Admission Exam: JULY 2019

DRAWING TEST
 (5 hours)

Inside the Bucharest Village Museum, a new pavilion dedicated to promoting architecture was built, hosting architectural exhibitions, conferences, professional meetings, etc.

The building has both glazed and opaque facades, according to the presented plan, facade and section.

The access inside the pavilion is done through an oak double-door, recovered from a historical building.

The representation also suggests the lay-out of the interior space which includes:

- a vertical parallelepipedal volume (V) for displaying projects;
- an exhibition platform (P) at 3,00 m high, accessible through a stair;
- an exhibition table (M).

It is proposed to illustrate a 6 moments visit, as it follows.

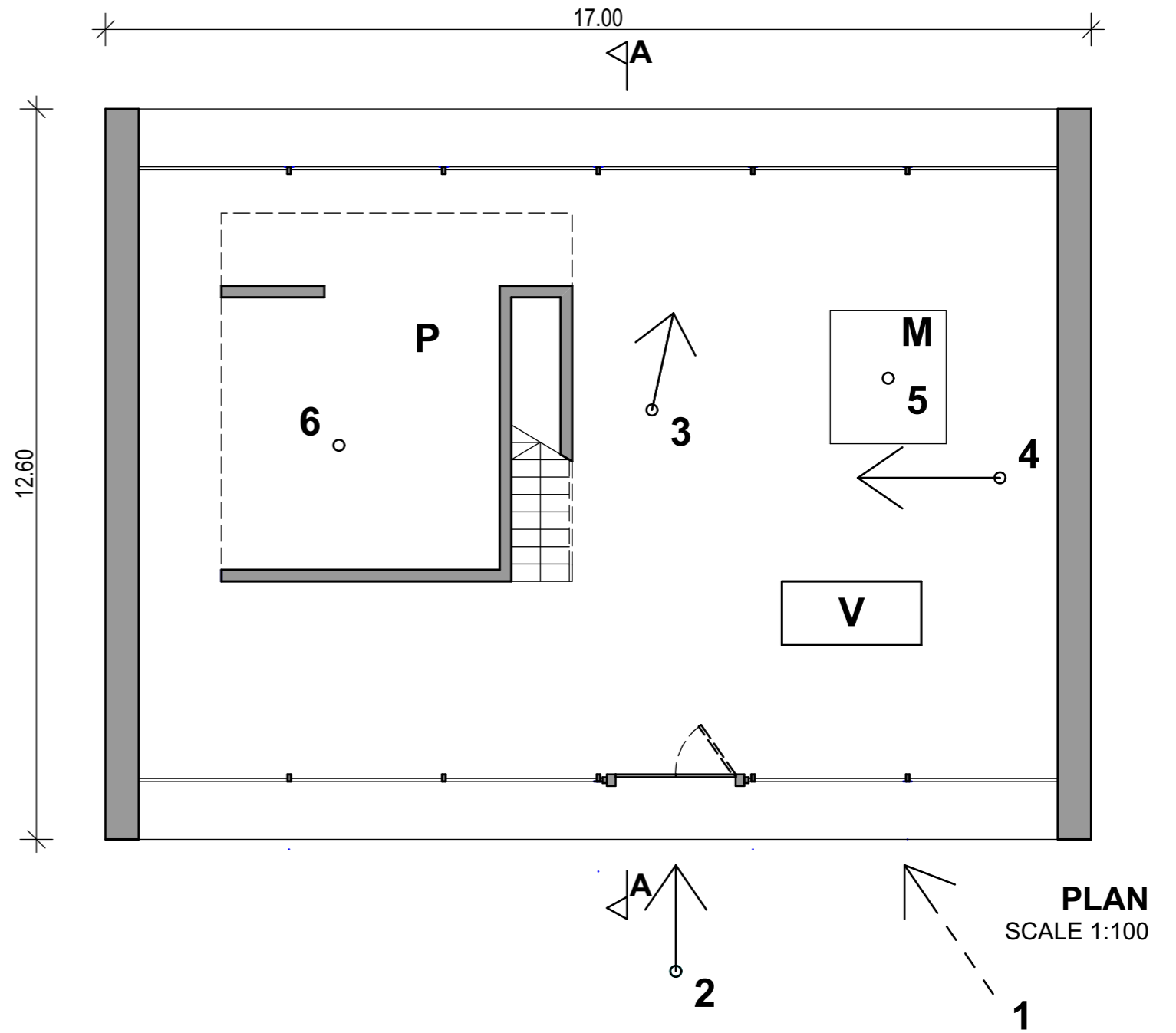

FACADE
 SCALE 1:100

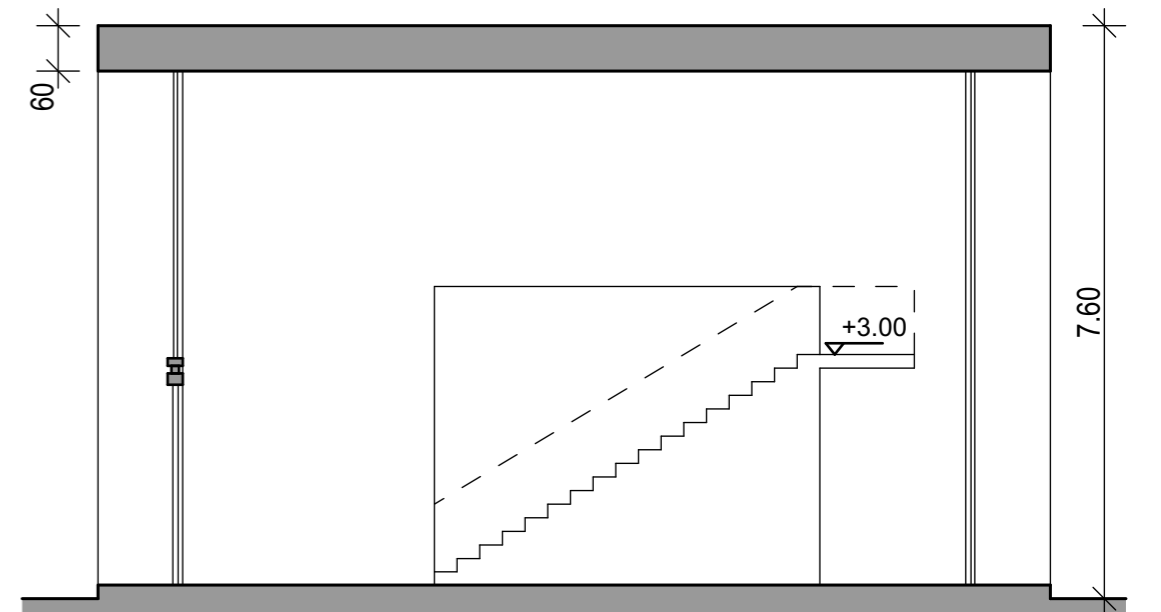

SECTION A-A
 SCALE 1:100

The subjects will be solved on a white sheet of paper, 50 x 70 cm (respecting the layout below).

Moment 1

Draw an exterior eye-level perspective from direction 1 (marked on plan) looking at the pavilion. It is required a full representation of the pavilion, adding elements of architectural ambience: materials, textures, entourage. The representation with lights and shadows will be done in graphite pencil.

Moment 2

Draw an eye-level perspective from point and direction 2 (marked on the plan) towards the access door of the pavilion, having one door-leaf closed and the other opened, according to the plan. The representation will be done in colored pencils, expressing materials, textures, lights and shadows.

Moment 3

Draw an eye-level perspective from point and direction 3 (marked on the plan), knowing that you are inside, looking through the glazed facade towards a peasant house nearby the pavilion and which is entirely perceived. The representation with lights and shadows will be done in colored pencils.

Moment 4

Draw an eye-level perspective of the interior, from point and direction 4 (marked on the plan). It is required to imagine and represent the stair railing (indicated by dashed line on plan and section). The representation will be done in graphite pencil, expressing materials, textures, lights and shadows.

Moment 5

Exhibited on the table M is a children's toy made of 3 wooden pieces, parts of a cylinder of 6 cm in diameter and 9 cm in height, which is placed in a vertical position according to the adjacent view. Two of the pieces are identical, and the third one passes through the middle of the assembly holding it together. It is required to represent in an isometric axonometry at a 1:1 scale (1 cm in the drawing = 1 cm in reality), the components of the described assembly, each of them being placed on the table in a stable position. The representation will be done in graphite pencil, with lights and shadows.

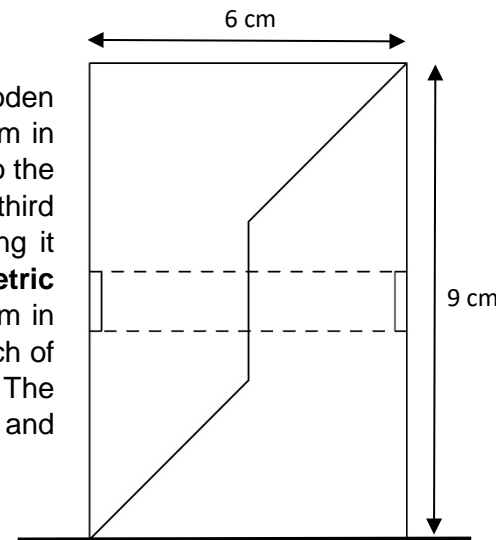

Moment 6

On platform P, located at +3.00 m, is displayed the model of the peasant house seen at Moment 3. The model is about 1 m high and it is placed on the floor. It is required to sketch an eye-level perspective of the model, in graphite pencil.

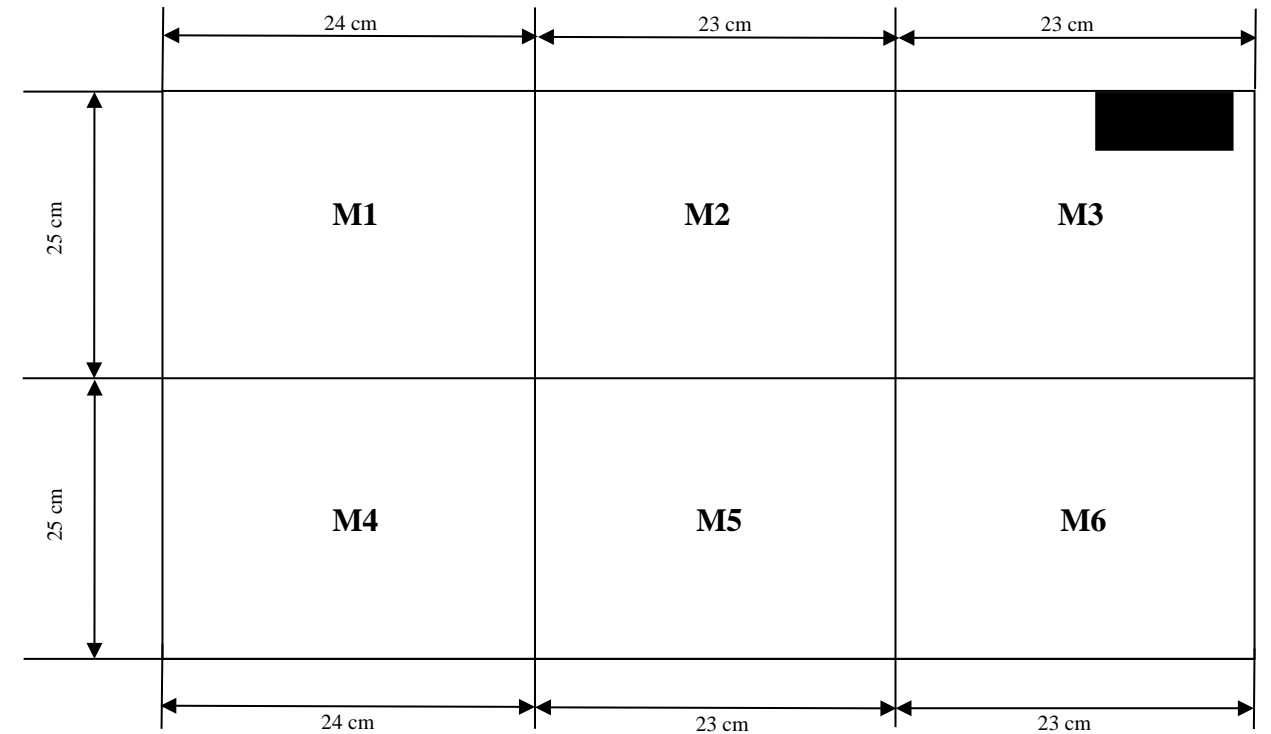

Note:

- All subjects are compulsory.
- The model of the layout is compulsory.
- None of the subjects is allowed to have represented other elements than those specified in the subjects.

Evaluation criteria:

- respecting the given themes;
- creativity;
- spatial perception and representation;
- the correct solving of the subjects;
- the graphic presentation expressivity and accuracy.